

How to switch the interface



1.Short touch the screen to enter into new system while in original radio interface



2.Return back to original system by touching the Go Back to Original system icon

④

Security considerations

Announcements:

- ◆ Pls check the appearance and the unit functions before install the unit.
- ◆ Don't shorten or extend the GPS antenna, it will lead to the antenna problem.
- ◆ Don't make the GPS antenna winding the steering wheel and shift lever, it will be dangerous.

Warm prompt

1. Don't use strong chemicals, cleaning agents, strong detergent to washing the machine
2. Please use a clean soft fabric to wipe the screen, don't use ordinary fabric
3. Please use the touch screen pen to operation unit, please don't use other sharp objects, or it will damage to the screen
4. Please don't self-service, maintenance or install the unit, in case of the power is on, don't install or repair the unit. It is very dangerous if the person who did not receive the electronic equipment or vehicle installation training or lack of experienced personnel to install and repair the unit.
5. Please protect the original display when the staff dismantling the original CD and keep the original CD, try to use the original screw.
6. Navigation and rearview camera only do auxiliary function, it can't replace your attention and judgment.
7. When the customer choose the digital TV, our unit could realized the digital TV touch.

The publicity material only for reference, we don't make the further notice if the information have any changes, our company has the final explanation right!

Installation Instruction and Things to Note

Audi A1 GPS navigation & Audio System



Installation Procedure



1.Original car console 2.Pry the emergency switch and unplug the connector



3.Remove the screws which fixed the display screen 4.Pry the snap joints at left and right side and unplug the connectors

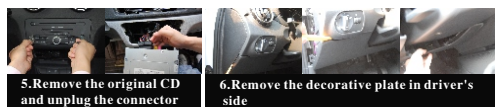

5.Remove the original CD and unplug the connector 6.Remove the decorative plate in driver's side



7.Convert the CAN BUS connector to original CANBUS, its by the side of fiber optic cable under driver's seat 8.Wiring the display screen convert cable to console

①

Installation Procedure

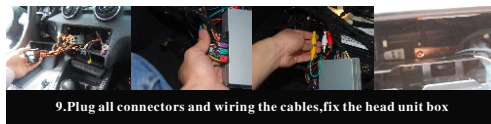

9.Plug all connectors and wiring the cables,fix the head unit box



10.Connect the GND (Ground Cable) to the body of original CD player and put it back 11.Fixed the external microphone to A pillar



12.Plug the mini speaker



13.After installation

②

Instruction to setting the sounds output

1.Setting the head unit's sound out from original speakers



First of all, enter into original system and go to Media interface. Activating the AUX, then press MEDIA button in original CD's panel to switch between original radio, CD and our system's sounds.

2.Setting the navigation sounds output from mini speaker while listening original radio or CD



Turn to CD or radio interface and touch screen 3 seconds to enter into navigation (or press NAVI button in steering wheel), now the original CD or radio will play continually and navigation sound will output from mini speaker.

③